

## Clubhouse Refurbishment – An Overview For Members

We have a 3 Phase plan to refurbish the interior of the clubhouse. This involves new flooring, furniture, fixtures and fittings and redecoration during each phase of work. The headlines for each phase of refurbishment are outlined below.

Phase 1 – Redevelopment of the lower level of the main clubhouse into a multi-functional casual space.

- High and standard level tables and chairs that can be used for dining / drinking
- A relaxed seating area with sofas
- Existing large TV to be wall mounted
- A dart board will be installed



At the end of this phase the corridor from the Men's Locker Room to the entrance to the Main Lounge will be re-floored and decorated.

As we move through each phase of work our existing Honours Boards and pictures of Club Officials will be taken down and replaced at the end of the work by Digital Display Boards.

Phase 2 – The snooker room and the room adjacent to it will be combined to create a large, multi-use area. While the snooker room is used by a small number of members it is a large part of clubhouse space that can be better utilised to generate revenue for the club. As part of this phase the toilets at this end of the clubhouse will be upgraded.

- Day to day the space will be configured as a conventional dining / drinking area with seating and tables. Ideal for our larger societies.
- There is sufficient room to accommodate a Band / DJ and a dancing spacing by reconfiguring the table layout (there are multiple ways this can be done allowing it to be combined with the main lounge for larger functions).
- The tables can also be reconfigured to create a conference space.

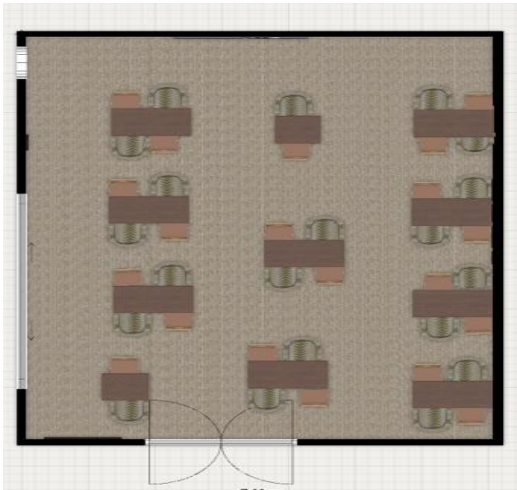

Phase 3 – The current main lounge and bar will also be refurbished. In terms of seating there will be only minor changes to how this area is configured today. The focus of the changes in this area is to transform the way it looks through new flooring, furniture, decoration and fixtures and fittings.



Board of Directors